

NOTES:
ALL TRAFFIC MANAGEMENT TO BE IN ACCORDANCE WITH CHAPTER 8 OF THE TRAFFIC SIGNS MANUAL AND THE TSRGD 2002, AND INSTALLATION, MAINTENANCE AND DISMANTLE METHODS MUST COMPLY WITH HEADWAY TRAFFIC MANAGEMENT'S RELEVANT METHOD STATEMENT(S).

- P1** 35 Seconds Green
5 Seconds Red
- P2** 35 Seconds Green
5 Seconds Red
- P3** 35 Seconds Green
5 Seconds Red

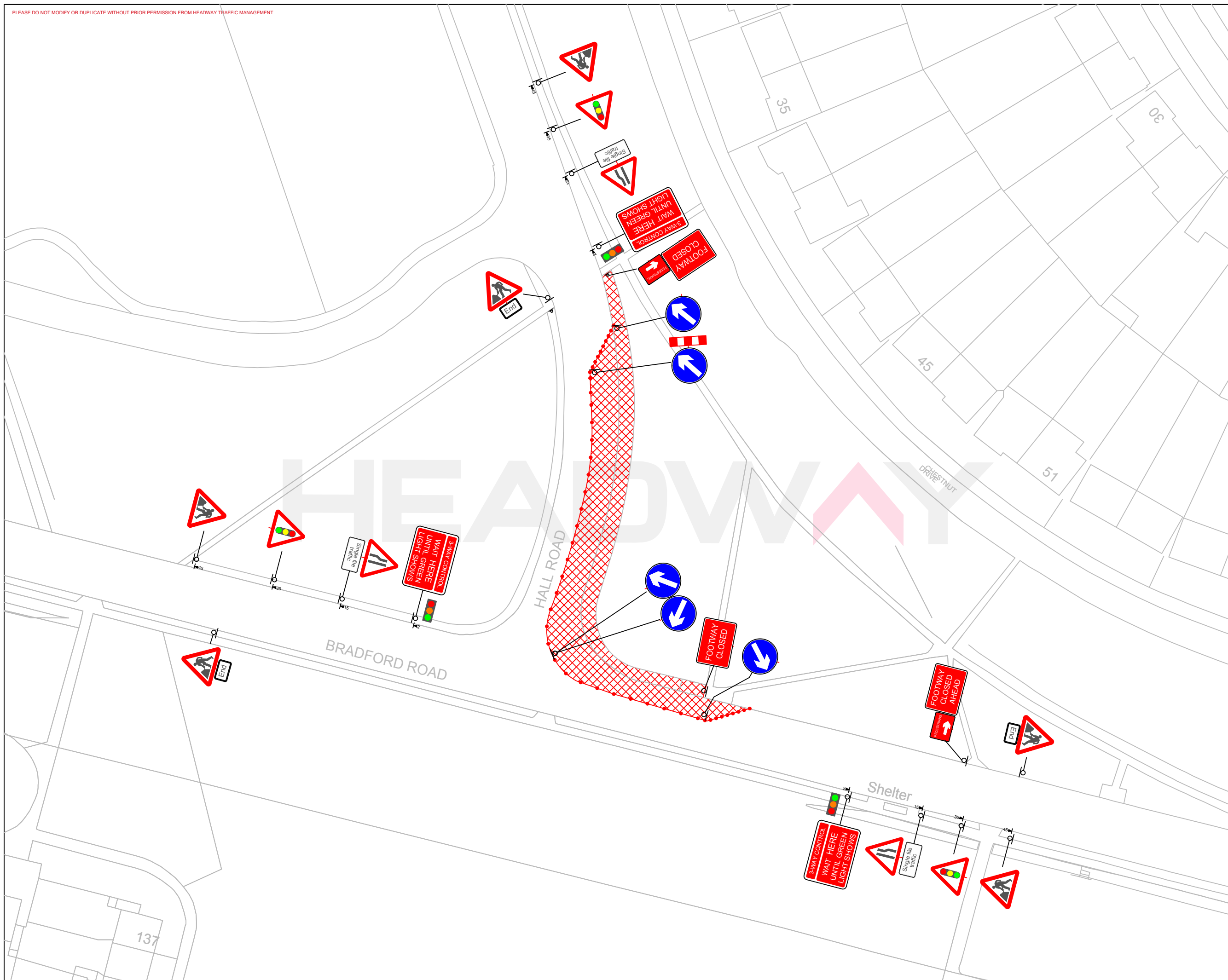

HEADWAY
TRAFFIC MANAGEMENT

MacDonald SURFACING

PROJECT:
3 Way Lights With Ped Diversion P2

SITE ADDRESS:
Hall Road, Solihull

DRAWN BY: T.McMaster	DATE: 07/05/2019
CHECKED BY: C.Moran	OUR REF: 1
REF:	REVISION: 2