





PLEASE DO NOT MODIFY OR DUPLICATE WITHOUT PRIOR PERMISSION FROM HEADWAY TRAFFIC MANAGEMENT

NOTES:  
ALL TRAFFIC MANAGEMENT TO BE IN ACCORDANCE WITH CHAPTER 8 OF THE TRAFFIC SIGNS MANUAL AND THE TSRGD 2002, AND INSTALLATION, MAINTENANCE AND DISMANTLE METHODS MUST COMPLY WITH HEADWAY TRAFFIC MANAGEMENT'S RELEVANT METHOD STATEMENT(S).

-  Traffic Light Heads
-  Cones
-  Working Area
-  Pedestrian Barrier

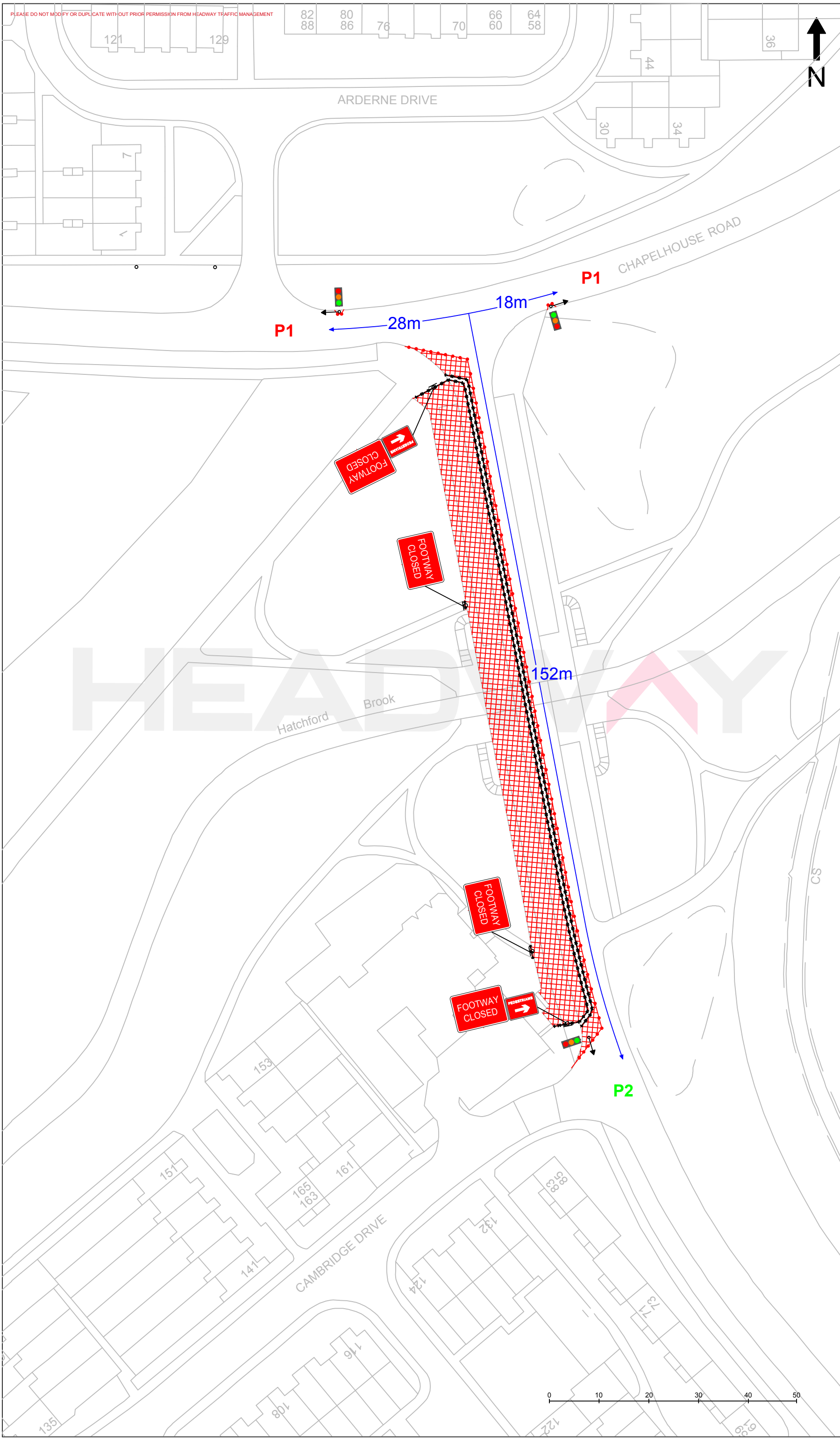

**HEADWAY**  
TRAFFIC MANAGEMENT

CLIENT:  
**MacDonald SURFACING**

PROJECT:  
**(Phase 3)  
3 Way Lights  
2 Phase running  
Ped Walkway**

SITE ADDRESS:  
**Gloucester Way Jnc  
Moorend Avenue,  
Birmingham**

DRAWN BY: <b>L.Satchwell</b>	DATE: <b>02/09/2019</b>
CHECKED BY: <b>C.Owen</b>	OUR REF.:
REF.:	REVISION: <b>P3 1</b>

