



PLEASE DO NOT MODIFY OR DUPLICATE WITHOUT PRIOR PERMISSION FROM HEADWAY TRAFFIC MANAGEMENT



NOTES:
ALL TRAFFIC MANAGEMENT TO BE IN ACCORDANCE WITH CHAPTER 8 OF THE TRAFFIC SIGNS MANUAL AND THE TSRGD 2002, AND INSTALLATION, MAINTENANCE AND DISMANTLE METHODS MUST COMPLY WITH HEADWAY TRAFFIC MANAGEMENT'S RELEVANT METHOD STATEMENT(S).

 Cones

 Working Area

 Pedestrian Barrier

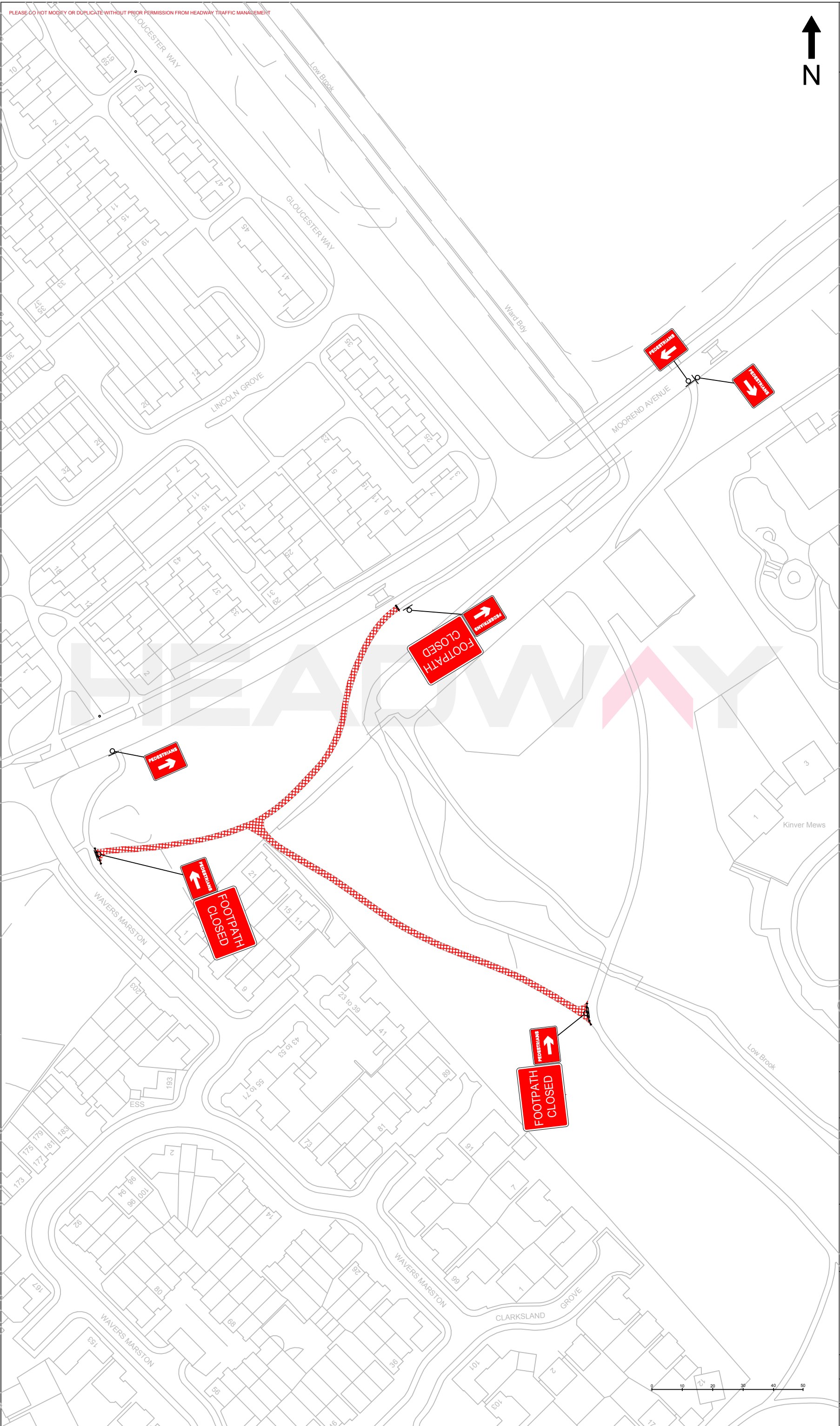

HEADWAY
TRAFFIC MANAGEMENT

CLIENT:
MacDonald SURFACING

PROJECT:
**(Phase 4)
Footpath Closure
Diversion**

SITE ADDRESS:
**Gloucester Way Jnc
Moarend Avenue,
Birmingham**

DRAWN BY: **L.Satchwell** DATE: **03/09/2019**

CHECKED BY: **C.Owen** OUR REF:

REF: **P4** REVISION: **1**

