



PLEASE DO NOT MODIFY OR DUPLICATE WITHOUT PRIOR PERMISSION FROM HEADWAY TRAFFIC MANAGEMENT

NOTES:
ALL TRAFFIC MANAGEMENT TO BE IN ACCORDANCE WITH CHAPTER 8 OF THE TRAFFIC SIGNS MANUAL AND THE TSRGD 2002, AND INSTALLATION, MAINTENANCE AND DISMANTLE METHODS MUST COMPLY WITH HEADWAY TRAFFIC MANAGEMENT'S RELEVANT METHOD STATEMENT(S).

-  Cones
-  Working Area
-  Pedestrian Barrier

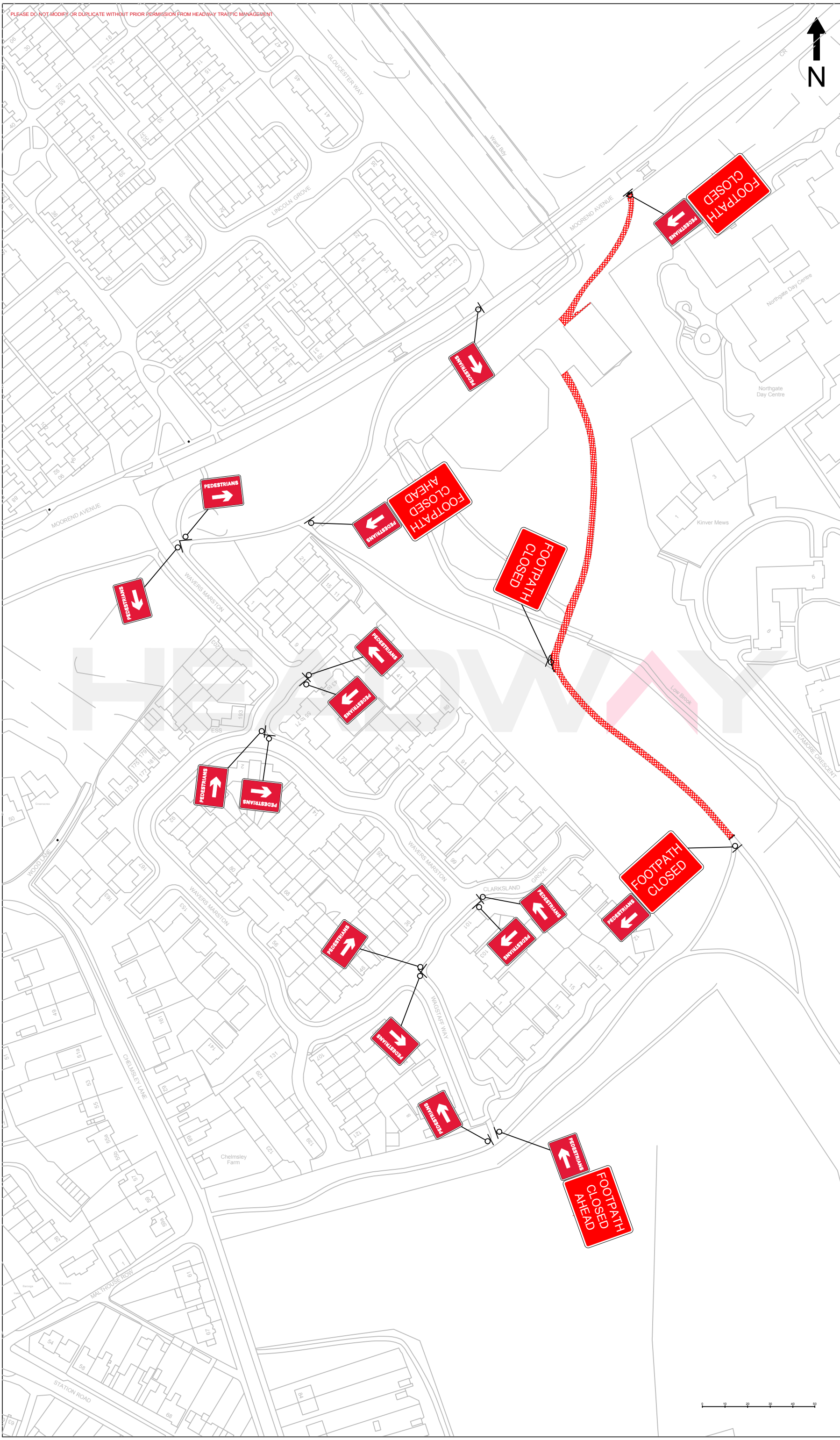

HEADWAY
TRAFFIC MANAGEMENT

CLIENT:
MacDonald SURFACING

PROJECT:
**(Phase 5)
Footpath Closure
Diversion**

SITE ADDRESS:
**Gloucester Way Jnc
Moorend Avenue,
Birmingham**

| | |
|---------------------------------|----------------------------|
| DRAWN BY: L.Satchwell | DATE: 03/09/2019 |
| CHECKED BY: C.Owen | OUR REF.: |
| REF: P5 | REVISION: 1 |